

U.S. Tsubaki Power Transmission, LLC
 U.S. Tsubaki Holdings, Inc.
 Corporate Headquarters
 301 E. Marquardt Dr.
 Wheeling, IL 60090 USA

Toll Free: 800.323.7790

Phone: 847.459.9500

Fax: 847.459.9515

Email: sales@ustsubaki.com

Website: www.ustsubaki.com

FEEDER BREAKER CHAINS

Leveraging over a century of mining/aggregate conveying experience, Tsubaki is proud to offer a market leading portfolio of premium heavy duty feeder/breaker chains. These offerings are each uniquely

[+ more](#)

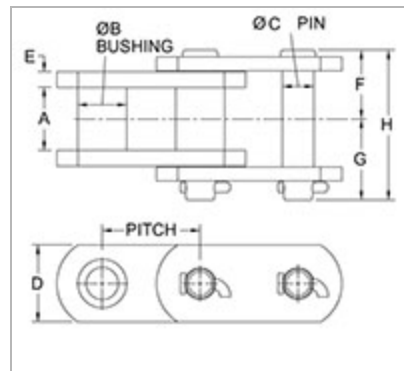

| <u>Item #</u> | <u>Pitch</u> | <u>Inside Width - A</u> | <u>Bushing Diameter - B</u> | <u>Pin Diameter - C</u> | <u>Sidebar Height - D</u> | <u>Sidebar Thickness - E</u> | <u>Pin Head to CL - F</u> | <u>Pin End to CL - G</u> | <u>Overall Width - H</u> |
|---------------|----------------------|-------------------------|-----------------------------|-------------------------|---------------------------|------------------------------|---------------------------|--------------------------|--------------------------|
| <u>FB3067</u> | 3.067 in | 1.56 in | 1.50 in | 0.75 in | 2.25 in | 0.38 in | 1.72 in | 2.13 in | 3.8 |
| <u>FB3075</u> | 3.075 in | 1.31 in | 1.25 in | 0.68 in | 1.50 in | 0.38 in | 1.63 in | 1.88 in | 3.5 |
| <u>FB3035</u> | 3.000 in 3.500 in | 1.88 in | 1.50 in | 0.99 in | 2.50 in | 0.56 in | 2.28 in | 2.72 in | 5.0 |
| <u>FB3040</u> | 3.000 in 4.000 in | 1.88 in | 1.50 in | 0.99 in | 2.50 in | 0.56 in | 2.28 in | 2.72 in | 5.0 |
| <u>FB3500</u> | 3.500 in | 2.25 in | 1.75 in | 1.13 in | 2.75 in | 0.56 in | 2.47 in | 2.91 in | 5.3 |
| <u>FB3750</u> | 3.750 in | 2.25 in | 1.75 in | 1.19 in | 2.75 in | 0.56 in | 2.53 in | 2.84 in | 5.3 |
| <u>FB4000</u> | 4.000 in | 1.94 in | 1.75 in | 0.94 in | 2.38 in | 0.56 in | 2.45 in | 2.75 in | 5.2 |
| <u>FB4500</u> | 4.500 in | 2.75 in | 2.38 in | 1.37 in | 3.50 in | 0.63 in | 2.91 in | 3.34 in | 6.2 |
| <u>FB5500</u> | 5.500 in | 2.75 in | 2.50 in | 1.46 in | 4.00 in | 0.75 in | 3.19 in | 3.63 in | 6.8 |

| <u>Item #</u> | <u>Pitch</u> | <u>Inside Width - A</u> | <u>Bushing Diameter - B</u> | <u>Pin Diameter - C</u> | <u>Sidebar Height - D</u> | <u>Sidebar Thickness - E</u> | <u>Pin Head to CL - F</u> | <u>Pin End to CL - G</u> | <u>Over Width - H</u> |
|---------------|--------------|-------------------------|-----------------------------|-------------------------|---------------------------|------------------------------|---------------------------|--------------------------|-----------------------|
| <u>FB6000</u> | 6.000 in | 3.63 in | 2.75 in | 1.75 in | 4.50 in | 0.88 in | 3.84 in | 4.17 in | 8.00 in |