



U.S. Tsubaki Power Transmission, LLC
 U.S. Tsubaki Holdings, Inc.
 Corporate Headquarters
 301 E. Marquardt Dr.
 Wheeling, IL 60090 USA

Toll Free: 800.323.7790

Phone: 847.459.9500

Fax: 847.459.9515

Email: sales@ustsubaki.com

Website: www.ustsubaki.com

POWER-LOCK AS METRIC SERIES STAINLESS STEEL KEYLESS LOCKING DEVICE

- Corrosion protection
- Global standard for keyless shaft locking
- Built in tap holes for easy removal
- Metric size range: 19-mm thru 150-mm

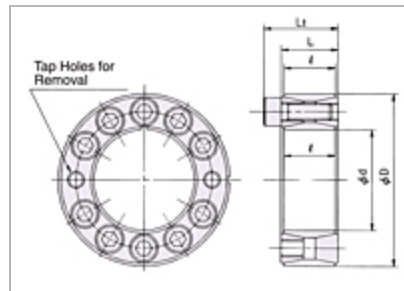

<u>Item #</u>	<u>d - Shaft O.D.</u>	<u>D - Hub Counter I.D.</u>	<u>L</u>	<u>I</u>	<u>Lt</u>	<u>Transmissible Torque</u>	<u>Quantity</u>
<u>PL019X047SS</u>	0.748 in	1.850 in	0.787 in	0.709 in	1.024 in	145 ft•lb	1
<u>PL020X047SS</u>	0.787 in	1.850 in	0.787 in	0.709 in	1.024 in	159 ft•lb	1
<u>PL022X047SS</u>	0.866 in	1.850 in	0.787 in	0.709 in	1.024 in	173 ft•lb	1
<u>PL024X050SS</u>	0.945 in	1.969 in	0.787 in	0.709 in	1.024 in	253 ft•lb	1
<u>PL025X050SS</u>	0.984 in	1.969 in	0.787 in	0.709 in	1.024 in	260 ft•lb	1
<u>PL028X055SS</u>	1.102 in	2.165 in	0.787 in	0.709 in	1.024 in	297 ft•lb	1
<u>PL030X055SS</u>	1.181 in	2.165 in	0.787 in	0.709 in	1.024 in	318 ft•lb	1
<u>PL032X060SS</u>	1.260 in	2.362 in	0.787 in	0.709 in	1.024 in	419 ft•lb	1
<u>PL035X060SS</u>	1.378 in	2.362 in	0.787 in	0.709 in	1.024 in	463 ft•lb	1
<u>PL038X065SS</u>	1.496 in	2.559 in	0.787 in	0.709 in	1.024 in	550 ft•lb	1
<u>PL040X065SS</u>	1.575 in	2.559 in	0.787 in	0.709 in	1.024 in	586 ft•lb	1

<u>Item #</u>	<u>d - Shaft O.D.</u>	<u>D - Hub Counter I.D.</u>	<u>L</u>	<u>I</u>	<u>Lt</u>	<u>Transmissible Torque</u>	<u>Quantity</u>
<u>PL042X075SS</u>	1.654 in	2.953 in	0.945 in	0.827 in	1.260 in	907 ft•lb	1
<u>PL045X075SS</u>	1.772 in	2.953 in	0.945 in	0.827 in	1.260 in	981 ft•lb	1
<u>PL048X080SS</u>	1.890 in	3.150 in	0.945 in	0.827 in	1.260 in	1040 ft•lb	1
<u>PL050X080SS</u>	1.969 in	3.150 in	0.945 in	0.827 in	1.260 in	1092 ft•lb	1
<u>PL055X085SS</u>	2.165 in	3.346 in	0.945 in	0.827 in	1.260 in	1468 ft•lb	1
<u>PL060X090SS</u>	2.362 in	3.543 in	0.945 in	0.827 in	1.260 in	1601 ft•lb	1
<u>PL065X095SS</u>	2.559 in	3.740 in	0.945 in	0.827 in	1.260 in	1888 ft•lb	1
<u>PL070X110SS</u>	2.756 in	4.331 in	1.102 in	0.984 in	1.496 in	2965 ft•lb	1
<u>PL075X115SS</u>	2.953 in	4.528 in	1.102 in	0.984 in	1.496 in	3179 ft•lb	1
<u>PL080X120SS</u>	3.150 in	4.724 in	1.102 in	0.984 in	1.496 in	3400 ft•lb	1
<u>PL085X125SS</u>	3.346 in	4.921 in	1.102 in	0.984 in	1.496 in	3975 ft•lb	1

<u>Item #</u>	<u>d - Shaft O.D.</u>	<u>D - Hub Counter I.D.</u>	<u>L</u>	<u>I</u>	<u>Lt</u>	<u>Transmissible Torque</u>	<u>Quantity</u>
<u>PL090X130SS</u>	3.543 in	5.118 in	1.102 in	0.984 in	1.496 in	4189 ft·lb	1
<u>PL095X135SS</u>	3.740 in	5.315 in	1.102 in	0.984 in	1.496 in	4772 ft·lb	1
<u>PL100X145SS</u>	3.937 in	5.709 in	1.299 in	1.142 in	1.772 in	6196 ft·lb	1